

Model: SDR45

2 GLIDE DOORS
REFRIGERATOR

2° ~ 4°C
(35.6 ~ 39.2 F)

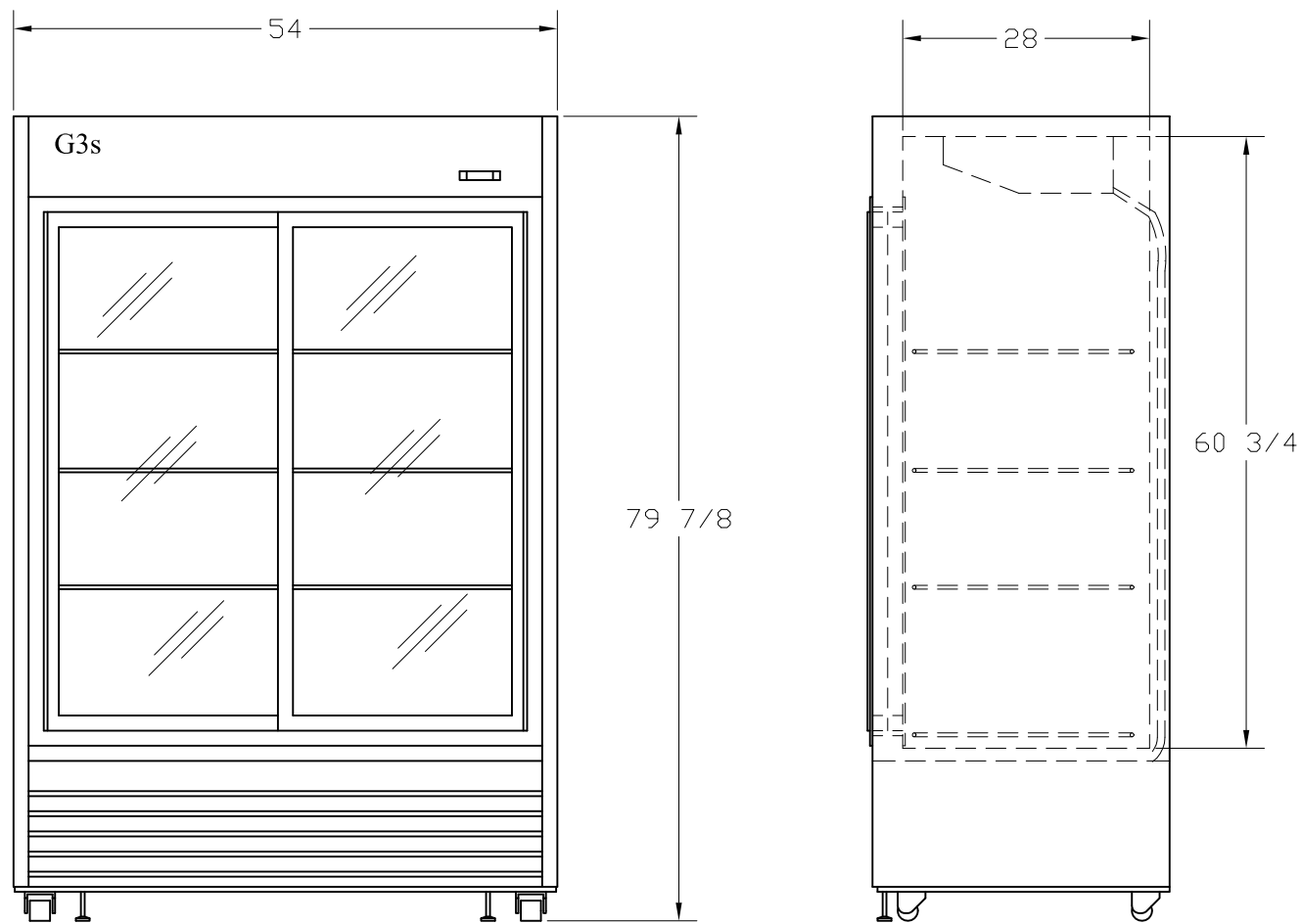
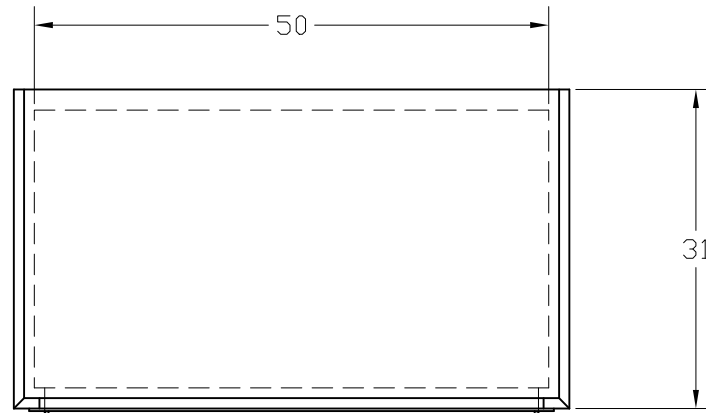

G3s

Tel. 609-510-3396 www.green3s.com

ECN: 3001	Rev: DR	Date: 2/1/2013	Scale: NA
-----------	---------	----------------	-----------

Model: SDR45

GENERAL SPECIFICATIONS

EXTERIOR: 54"W X 32"D X 80"H
POWDER COATED STEEL WHITE
INTERIOR (CUBIC FEET): 45
50"W X 28"D X 60 3/4"H
POWDER COATED STEEL WHITE
DOUBLE-PANE GLASS SLIDING DOOR
SELF-CLOSING, FULL-LENGTH HANDLE (2x)
LED INTERIOR LIGHT
2" CFC FREE INSULATION
LED DIGITAL TEMPERATURE READOUT
TEMPERATURE RANGE: 2°C TO 4°C
SHELVES: (8x) 24"W x 24"D WIRE SHELVES
VINYL-COATED ADJUSTABLE
CONDENSING UNIT: 1/2 HP
ELECTRICAL : 115-60-1
POWER CORD & PLUG: PROVIDED
MINIMUM CIRCUIT AMP SIZE: 15
TOTAL AMP DRAW: 7
REFRIGERANT: R134a
FOUR (4) HEAVY-DUTY CASTERS
WITH FRONT LEVEL LEGS
WEIGHT: 550#

OPTIONS

SS INTERIOR/EXTERIOR
STAINLESS STEEL DRAWER(S)
ADDITIONAL SHELVES
G3s TEMPERATURE VIEWER
DIGITAL MONITOR/RECORDER COMBINATION
TR724 - TEMPERATURE RECORDER
AMS - ALARM/MONITOR SYSTEM
RMS - REMOTE MONITOR SYSTEM
RECORDER CHARTS AND PENS
- CHART 38-17 (-17°C TO 38°C)
- CHART 0-60 (0°C TO -60°C)
- INK PEN SET CRP-01

NOTE: DESIGN OR SPECIFICATIONS
SUBJECT TO CHANGE WITHOUT NOTICE